



Replacement Instruction Booklet

BRK 700 Series Alarm with Push-fit Base

Scan for More Information



safelincs.co.uk/replace-brk

ATTENTION:

Replace all alarms in the system together to maintain optimum system operation; failing to do so may compromise interlink performance.

Important!

easichange[®]

The included 9V battery must be inserted before installing the alarm. Follow the instructions below to fit the battery:

1

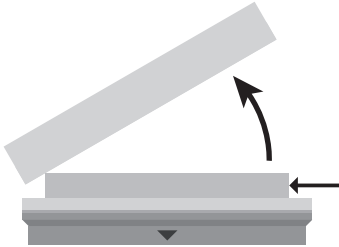

Open Alarm

2

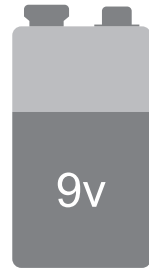

Insert Battery

3

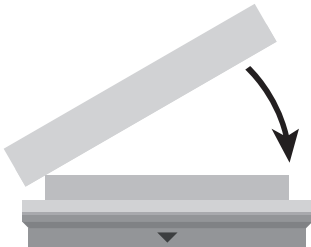

Close Alarm

4

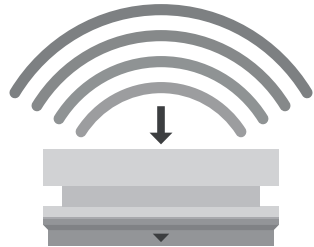

Test Alarm

Push Fit - Replacing Your Alarm

1

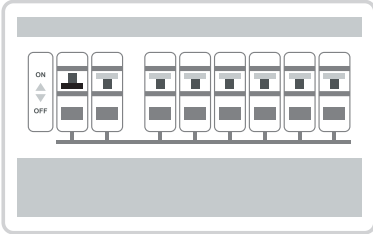

Turn the power off to all alarms in the property

2



Use a screwdriver to unclip the alarm from the baseplate

3

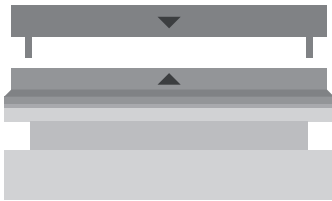

Line up the arrow on the new alarm to the arrow on the base plate

4

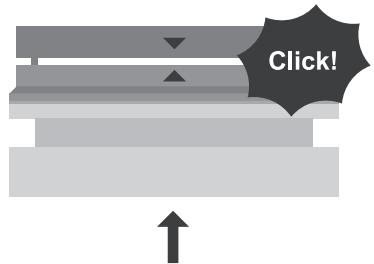

Push it towards the ceiling until you hear it click

Push Fit - End of Life Full Removal

1

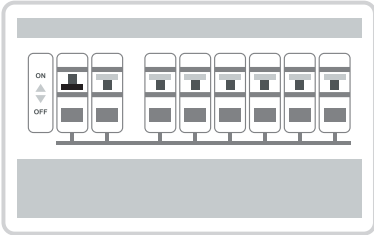

Turn the power off to all alarms in the property

2

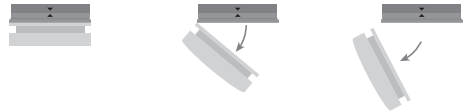

Press button on the side to remove the alarm by unhooking from the base

3

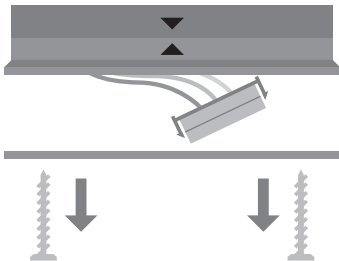

Unscrew and unplug the base from the adapter

4



Use a screwdriver to disconnect the adapter from the push fit base